

Tech Tip



Tech Tip

NO. 00001 PAGE 1 of 1

N170S NuVinci HUB

Drive Train Clicking

June 27, 2007 REV. 001

PART NUMBERS:

N170S Serial # All with external freewheel

DESCRIPTION:

Clicking or knocking sound heard when bike is pedaled.

PARTS REQUIRED:

B17-0220-00B Freewheel Adapter
RR62-0023 Retaining Ring

SERVICE OVERVIEW:

Verify chain tension is correct.

Verify that the clicking or knocking sound is coming from the freewheel.

To service freewheel adapter:

- 1) Remove the retaining ring with two small screwdrivers. One to pry up, the other to pry the ring out of the groove.
- 2) Remove the freewheel adapter together with the freewheel, by lifting it from the hub body.
- 3) Replace adapter/ freewheel and retaining ring with new parts.
- 4) Apply a light coat of grease on the splines and the threads of the adapter.
- 5) Install freewheel adapter onto input driver making sure the retaining ring is fully seated in the groove of the input driver.
- 6) Thread freewheel onto adapter.

TORQUE SPECS: N/A

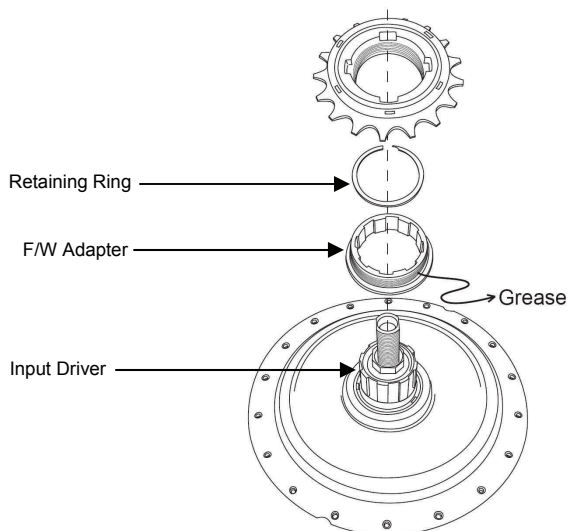

© 2008 NuVinci and Fallbrook Technologies and their stylized logos are trademarks or registered trademarks of Fallbrook Technologies Inc. All rights reserved. Printed in USA.

